

MATERIALS OF CONSTRUCTION:
 EPOXY COATED CAST IRON HOUSING
 DUCTILE IRON HANDWHEEL
 HEAT TREATED CARBON STEEL SLEEVES
 PLATED CARBON STEEL WORM SHAFT
 CARBON STEEL WORM AND WORM GEAR
 PLATED CARBON STEEL HARDWARE

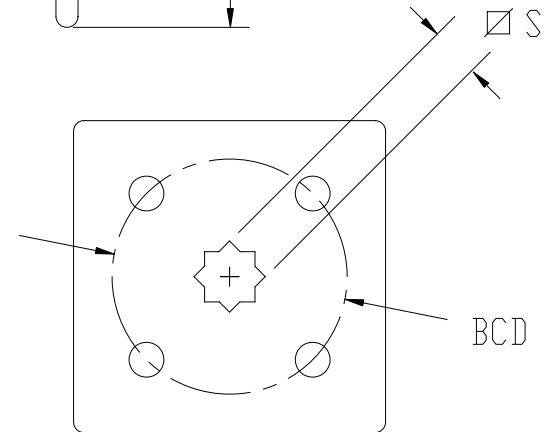

Note: Triple bolt circle patterns, "BCD" are not available on the same gear. Call factory for available options.

GEAR OPERATOR DIMENSIONS

MODEL NO.	REFERENCE SIZE	A	B	ØH (APPROX)	GEAR RATIO	TORQUE OUTPUT (lb in)	Ø S	BCD
GO-01-ISO	1 1/2" - 4"	1.67"	3.15"	4.0"	40 : 1	1330	11 mm	F05/F07
GO-02-ISO	5" - 6"	1.97"	3.94"	5.0"	37 : 1	2200	17 mm	F07
GO-03-ISO	8" - 12"	2.09"	4.65"	8.0"	42 : 1	4425	22 mm	F07/F10
GO-04-ISO	14"	2.60"	5.98"	12.0"	42 : 1	8850	27 mm	F10/F12/F14
GO-05-ISO	16" - 18"	3.50"	7.87"	12.0"	60 : 1	15900	46 mm	F12/F14/F16
GO-06	20"	4.84"	9.92"	16.0"	68 : 1	30090	CALL	F14/F16
GO-07	24"	6.02"	12.40"	16.0"	88 : 1	39825	CALL	F16/F25
GO-08	28" - 30"	1.97"	12.20"	16.0"	184 : 1	69900	CALL	F16/F25
GO-09	36"	3.74"	14.17"	16.0"	250 : 1	89395	CALL	F25/F30
GO-10	40"	9.45"	18.50"	20.0"	720 : 1	146030	CALL	F25/F30

DELTA T
 PRODUCTS



STANDARD GEAR
 OPERATOR ASSEMBLY

DATE: 8/21/2009 Revision No. 3

DRAWING BY: JSE